

Dear Wildlight Property Owners,

Greetings from the East Nassau Stewardship District. As you may be aware, your property is located within either Wildlight Village Phase 1 or Wildlight Village Phase 2. The East Nassau Stewardship District is approximately 23,600 acres, with Wildlight Village Phase 1 comprising of approximately 641 acres and Wildlight Village Phase 2 encompassing approximately 918 acres.

The East Nassau Stewardship District is a governmental entity empowered to plan, finance, construct, operate, and maintain public infrastructure improvements. Accordingly, since 2018 the East Nassau Stewardship District has financed public infrastructure improvements within Wildlight Village Phases 1 & 2. These improvements include public roads, mobility/public trails, stormwater management facilities, water, wastewater & reclaimed utilities, street lighting, common area landscaping, and entry features. The District is also responsible for maintaining these District owned public improvements within Wildlight Village Phases 1 & 2.

The District is now embarking on the planning process with the intent to finance and construct public infrastructure improvements within Wildlight Village Phase 3 and Preliminary Development Plan (PDP) #4. Currently, those properties are owned by the Master Developer and its affiliated entities. **Property owners located within Wildlight Village Phases 1 & 2 will not pay any of the expenses associated with the planned District financing of public infrastructure development within Wildlight Village Phase 3 or Preliminary Development Plan (PDP) #4. Those District public infrastructure development costs will be financed by the District and repaid by the future benefitted property owners located within Wildlight Village Phase 3 and Preliminary Development Plan (PDP) #4.**

Accordingly, over the next several months, you will see East Nassau Stewardship District published notices posted in the newspaper that are related to the aforementioned Wildlight Village Phase 3 and Preliminary Development Plan (PDP) #4 public infrastructure development plan. The East Nassau Stewardship District Board and Staff wanted to provide this information to you in advance of these published notices and assure you that none of these Wildlight Village Phase 3 and Preliminary Development Plan (PDP) #4 District financed public infrastructure development costs will be incurred by the property owners located within Phases 1 & 2 of Wildlight Village. Additional information can be found by visiting www.wildlightnextchapter.com.

On the behalf of the East Nassau Stewardship District Board of Supervisors and Staff, we'd like to wish everyone a Happy Holiday season!

Blue outline area below is Village Phase 3:

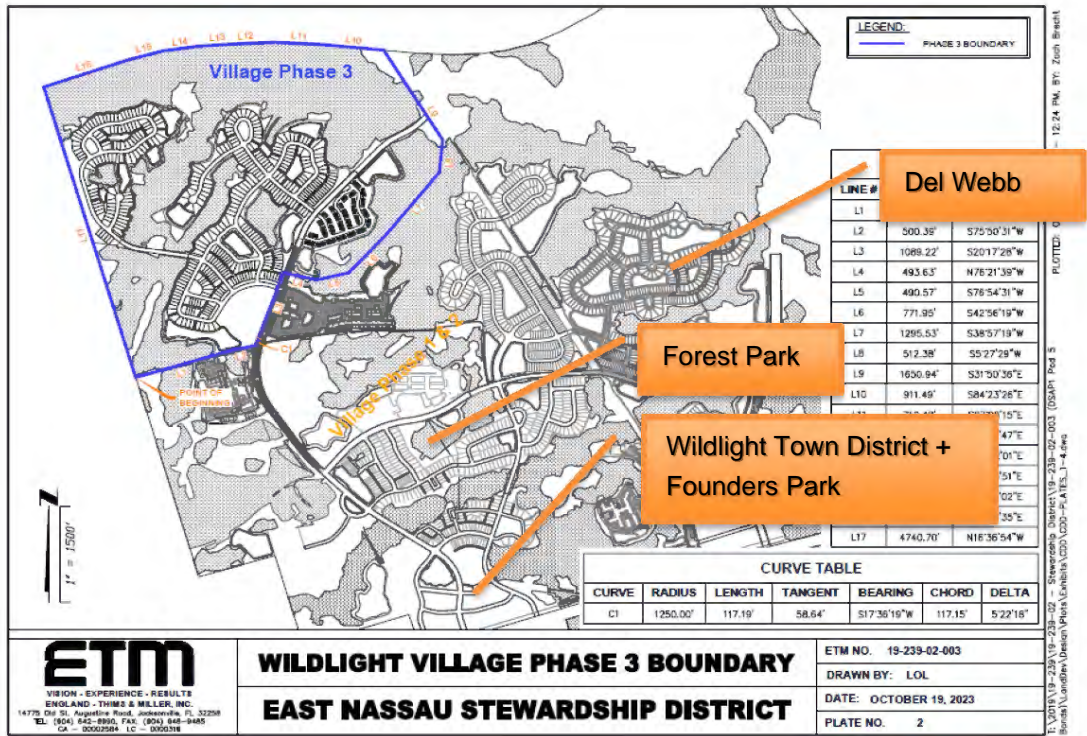

Blue outline area below is PDP #4:

